

James White.

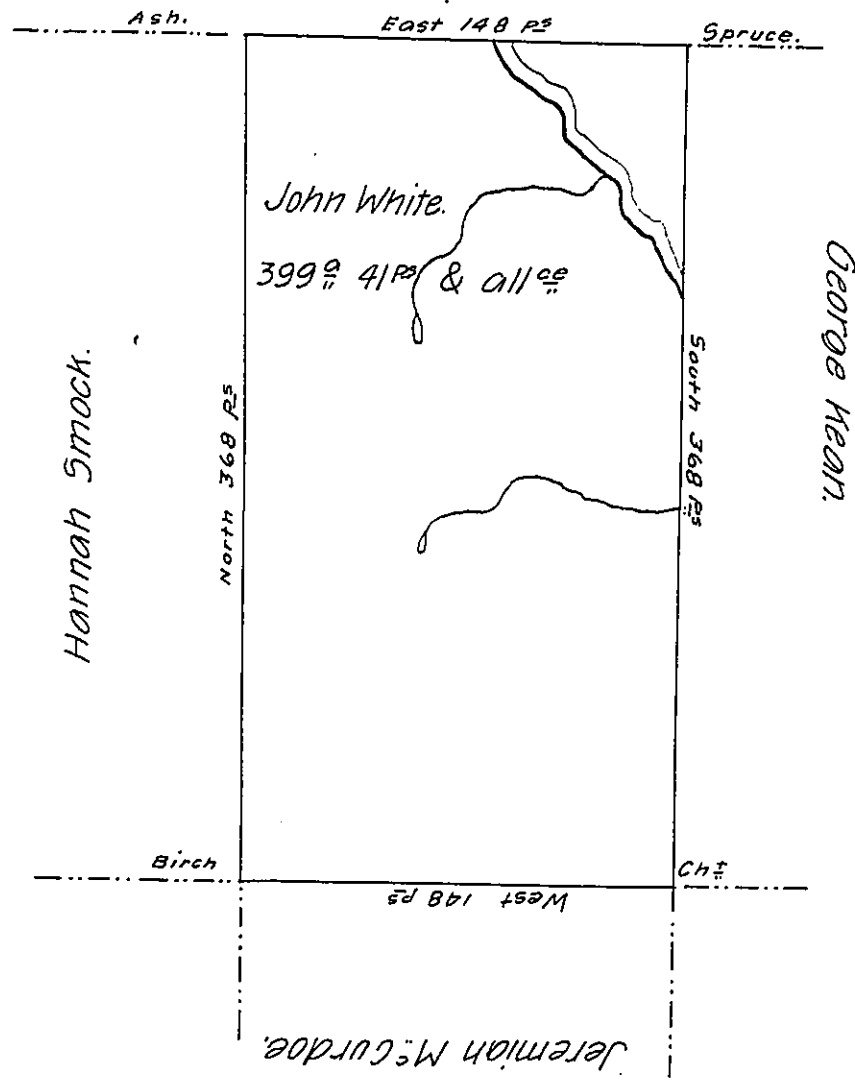

Situate on the East side of French Creek in the County of Allegheny adjoining lands of James White and others Containing 399^o & 41 perches with the usual allowance & s Surveyed the 28th day of May, 1795 in pursuance of his Improvement bearing date the 27th day of May, 1795.

W^m Power D^{se},

To Daniel Brodhead, Esq^o,

Surveyor General.

IN TESTIMONY that the above is a copy of the original remaining on file in the Department of Internal Affairs of Pennsylvania, made conformably to an Act of Assembly approved the 16th day of February, 1833, I have hereunto set my Hand and caused the Seal of said Department to be affixed at Harrisburg, this twenty eighth day of September, 1906.

Isaac R. Brown
Secretary of Internal Affairs.